

LUMOSIGNS
Trade Signage Solution

Magnetic

Lumo Sheet M

Change content in less than a minute,
unique magnetic technology.



ONE CLICK BACKLIT LIGHTING DESIGN

Lumo Sheet M



Quick and easy print replacement

- Frame thickness of just 15 mm (single or double-sided)
- Brightness up to 11000 lx on the surface depending on size
- Single or double sided, curved
- Low power consumption
- Wide application possibilities, from interior design to signage
- (OPAL) or clear acrylic 2 mm
- Easy changeable image print

One step, that's what you need to get your Lumo Sheet M LED panel ready. The product is one of the most popular advertising solutions for a reason. The magnet inside the frame seals the sheets in a second. Unseal them even quicker. Place the suction cup on the surface and replace the backlit (the print image inside the panel) instantly as many times as you need for your advertising purposes.

SUPPORT 24/7, PROTECTION & WARRANTY



VARIATIONS

1. Magnetic one-sided

Lumo Sheet M with a reflector covering the backlit acrylic panel emits light on the front side of the surface.

2. Magnetic two-sided

The diffuser in the magnetic LED panel composition replaces the reflector, so the backlit acrylic sheet emits light over its entire surface, both front and back.

3. Magnetic curved

Lumo Sheet M LED light panels may be either flat or curved. All designs feature high-quality resolution, homogenous and balanced intensity light. The curve depends on the size of the panel.

4. Portable stand – large

Choose a portable stand to your Lumo Sheet M panel. The largest stands start from 100 cm high.







5. Portable stand – medium

Medium size stands are up to 100 cm high and 50 cm width. The stand has curved legs.

6. Portable stand – small

The smallest portable stands you can pick are up to 50 cm high.

Technical specifications

<p>MAIN MATERIAL Clear acrylic (PMMA)</p>	<p>LUMINOUS EFFICIENCY up to 160 lm/W</p>	<p>POWER SUPPLY DC 12V / 24V / CC Adaptor</p>	<p>COLOUR TEMPERATURE</p> <ul style="list-style-type: none">  3000 K  4000 K  5000 K  6500 K  CCT (Special order)  RGB (Special order; except Magnetic Slim profile)
<p>FRAME THICKNESS 15 mm (S.S. and D.S.)</p>	<p>IP RATING IP 20</p>	<p>WORKING VOLTAGE DC 12V / DC 24V / DC CC <small>(RGB only 12 V)</small></p>	
<p>MAXIMUM SIZE FROM ONE SHEET 2800 x 1250 mm</p>	<p>LIFETIME > 50,000 hours</p>	<p>INPUT VOLTAGE AC 100 ~ 240V 50/60Hz</p>	
<p>MAXIMUM (PROFILE) LENGTHS 5000 mm</p>	<p>OPERATING TEMPERATURE -30°C ~ + 40°C</p>	<p>LED TAPE POWER one-sided 15 W/m two-sided 30 W/m</p>	

PACKAGE INCLUDES:

Power supply (Mean well GST series power supply)

Fixing & mounting

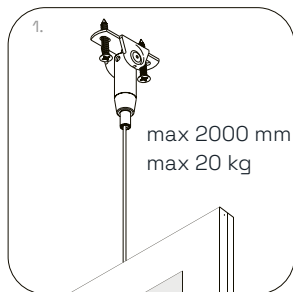
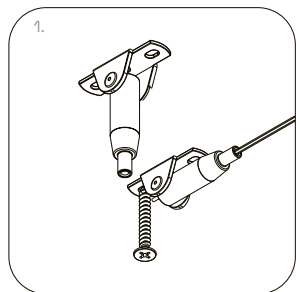

1. Two-point cable fixation

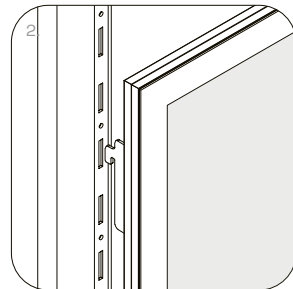
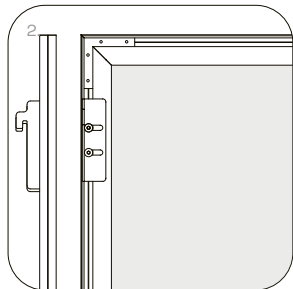
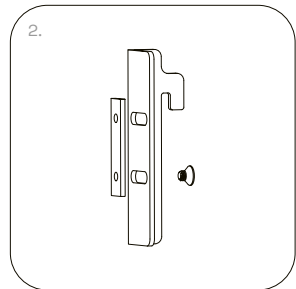

2. Gondola shelving

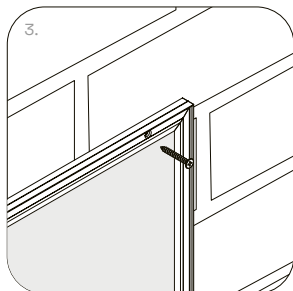
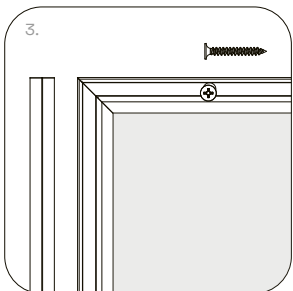
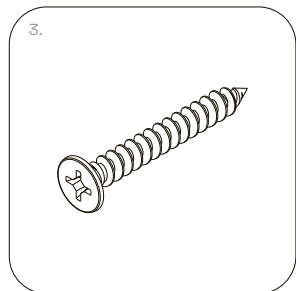

3. Pre-drill installation \varnothing 3,5 mm

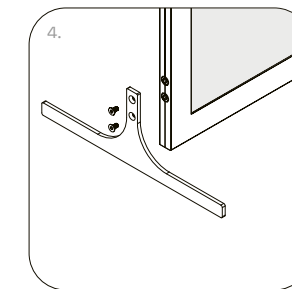
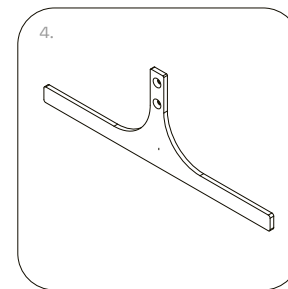
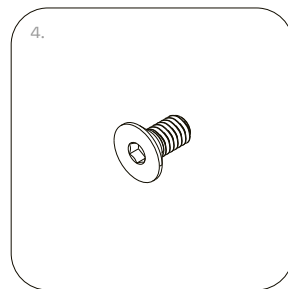

4. Portable stand. Small – up to 50 cm high

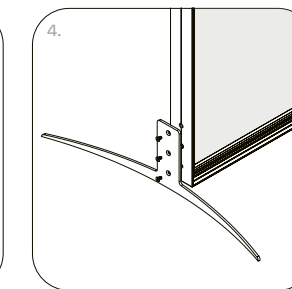
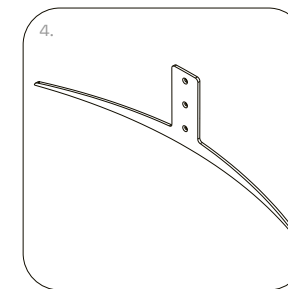
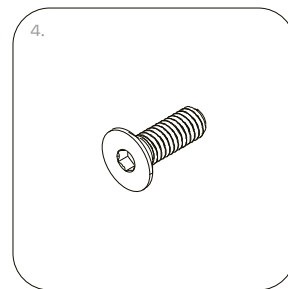

4. Portable stand. Medium – up to 100 cm high

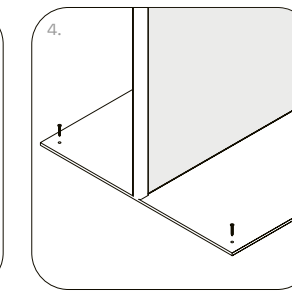
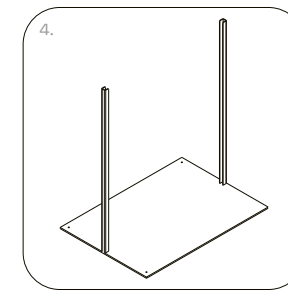
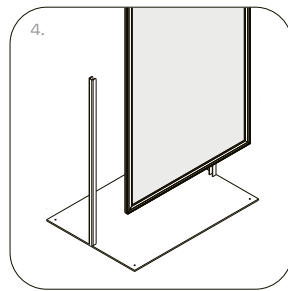

4. Portable stand. Large – up to 100 cm high

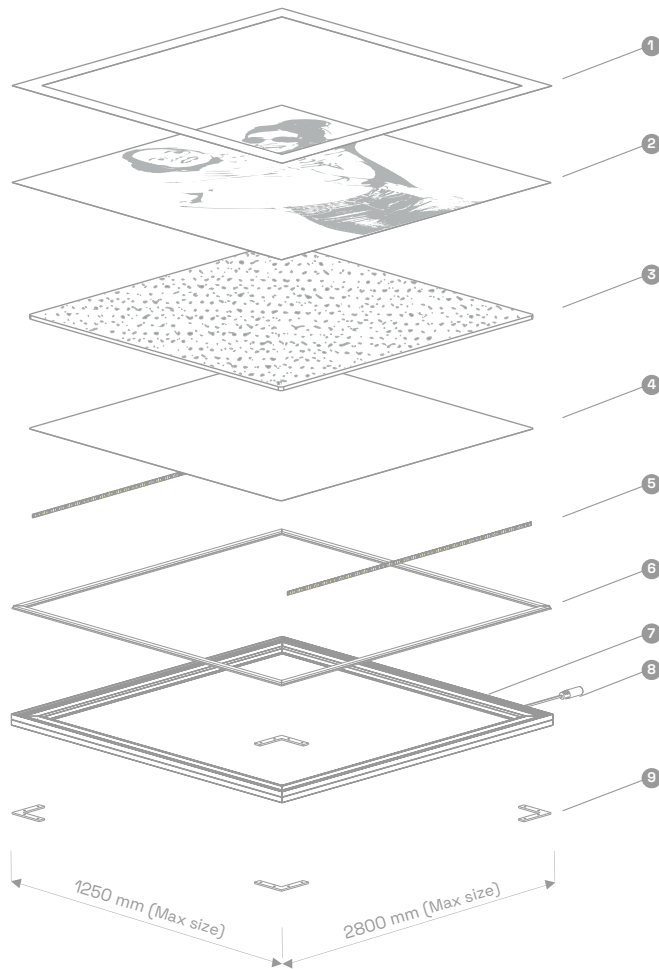

PRODUCT STRUCTURE

Technical & usage

- | | |
|--|-----------------------|
| 1. Protective acrylic sheet | 5. Lumosigns LED tape |
| 2. Print on backlit | 6. Magnet |
| 3. Lumosigns light-guided plate | 7. Aluminium frame |
| 4. Diffuser (double-sided) /
Reflector (single-sided) | 8. DC cable |
| | 9. Brackets |

Protective acrylic sheet

For your convenience, light panel with a protective acrylic sheet which ensures easy print change in just several minutes.

Print

The final step of the light panel is to choose, design and manufacture the desirable print you want to light up. Every standard back-lit and rigid print works perfectly with Lumosigns light panels.

Lumosigns light-guided plate

The most important part of the light panel is the acrylic sheet designed for even light distribution on the entire surface of the product, leaving no room for hot spots or darker areas you want to light up.

Reflector

A flexible material designed for supreme light reflection and color enhancement, making the most of LED lighting and acrylic sheet.

LED strips

High power LED strips with integrated Intelligent Control (IC) system for ultimate reliability and maximum lighting effect.

Magnetic frame

To deal with the heat LED bar is generating, high cooling efficiency aluminium frames are used to cool down the LED bar and to ensure optimal operating temperatures and long lifespan of the product.

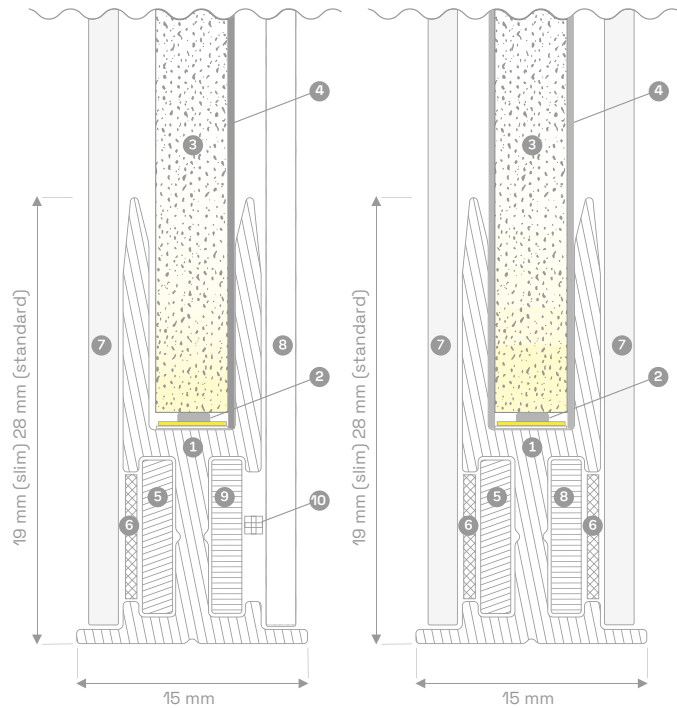

Magnetic Led panel - SINGLE

Magnetic Led panel - DOUBLE

PROFILES

Lumo Sheet M frame components

MAGNETIC LED PANEL - SINGLE

1. Aluminium frame
2. LED strips
3. Lumosigns light-guided plate
4. Reflector Lumosigns
5. Magnet
6. Metal strip
7. Protective acrylic sheet
8. Aluminum back plate (optional)
9. Brackets L shape
10. Screw

MAGNETIC LED PANEL - DOUBLE

1. Aluminium frame
2. LED strips
3. Lumosigns light-guided plate
4. Diffuser
5. Magnet
6. Metal strip
7. Protective acrylic sheet
8. Brackets



PRINT ON BACKLIT

Magnetic Standard profile: file preparation

The standard profile, as well as the magnetic passe-partout, have a width of 29 mm.

PRINTING SIZE

The print size should be 10 mm smaller from each border.

VISIBLE SIZE

Please note that the visible size is smaller than the printing size. The standard magnetic passe-partout is 29 mm in width.

DIGITAL PRINTING

For color profile and graphic file preparation for printing, please get in touch with your printing house.

CALCULATION EXAMPLE

EXTERNAL SIZE	PRINT SIZE	VISIBLE SIZE
500 x 700	480 x 680	442 x 642
1000 x 700	980 x 680	942 x 642
297 x 420 A3	277 x 400	239 x 362
594 x 840 A1	574 x 820	536 x 782
2800 x 1250 Max size	2780 x 1230	2742 x 1192



PRINT ON BACKLIT

Magnetic Slim profile: file preparation

The standard profile, as well as the magnetic passe-partout, have a width of 19 mm.

PRINTING SIZE

The print size should be 10 mm smaller from each border.

VISIBLE SIZE

Please note that the visible size is smaller than the printing size. The slim magnetic passe-partout is 19 mm in width.

DIGITAL PRINTING

For color profile and graphic file preparation for printing, please get in touch with your printing house.

CALCULATION EXAMPLE

EXTERNAL SIZE	PRINT SIZE	VISIBLE SIZE
500 x 700	480 x 680	462 x 662
1000 x 700	980 x 680	962 x 662
297 x 420 A3	277 x 400	259 x 382
594 x 840 A1	574 x 820	556 x 802
2800 x 1250 Max size	2780 x 1230	2762 x 1212

Lighting Projects



We are here to provide you with reliable services.
Because we are the ones

— who inspire through light

CONTACT:

Phone

UK: +44 (0) 330 8088 054
EU: +31 (0) 315 711729

Website

lumosigns.com

Email

sales@lumosigns.com